

DP3 Drill Press Fence

ASSEMBLY INSTRUCTIONS

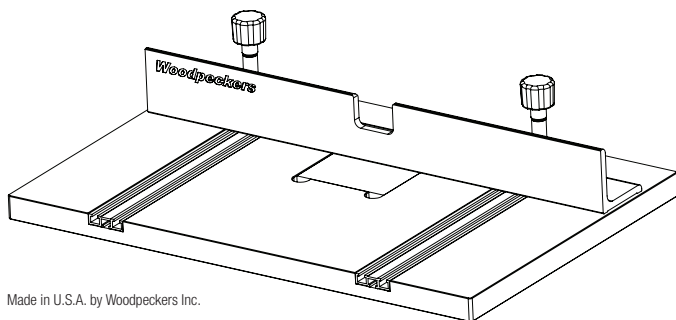

Made in U.S.A. by Woodpeckers Inc.

ASSEMBLING THE HARDWARE

The Woodpeckers® DP3 Drill Press Fence attaches to standard ¼" T-track which is typically installed flush with the surface of the table.

Figure 1 shows the arrangement of the seven hardware pieces that need to be assembled in the two holes of the fence. Notice that there are two holes at each end. The outside most holes are for attaching the DP3 fence to a Woodpeckers® Router Table. The inside two holes are for attaching to a Woodpeckers® Drill Press Table.

STEP 1. Begin by inserting a long bolt up through the bottom of the fence. From the top install a steel washer and a nylon spacer. Follow that by threading a hex nut all the way on.

Now slip the black tube over the hex nut and down over the nylon spacer.

Follow that up with another steel washer and finally the knob. Do not tighten the knob.

Repeat this same step for the other set of knob hardware.

STEP 2. Once both sets of hardware are loosely assembled on the fence, align the head of each long bolt with the T-track as shown in figure 2. Slide the fence to the desired position and tighten both knobs.

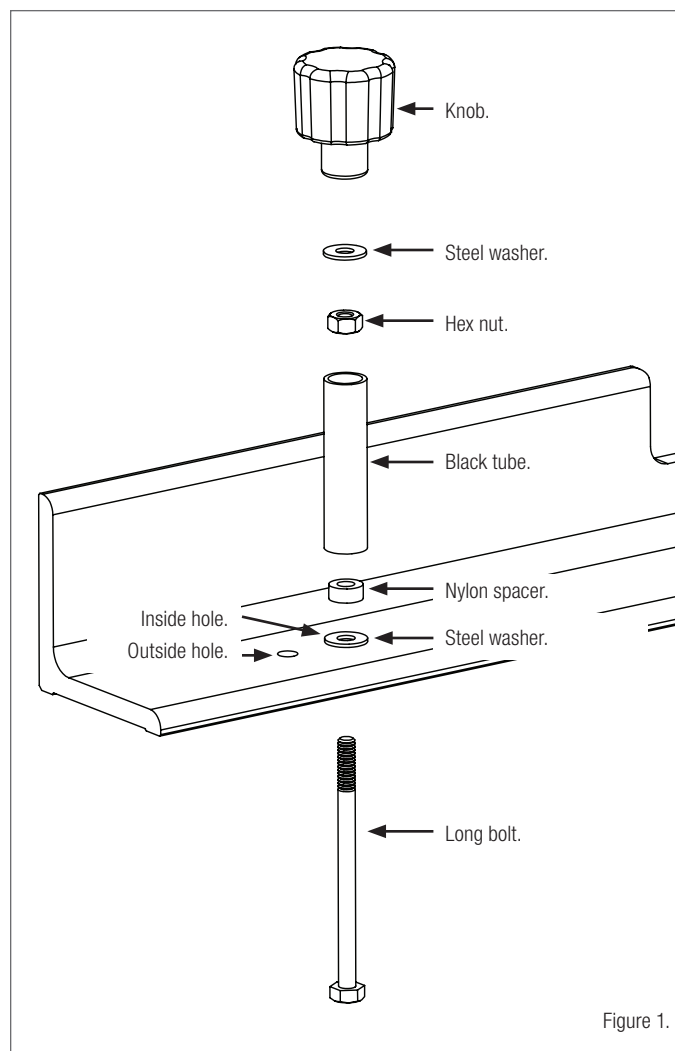

Figure 1.

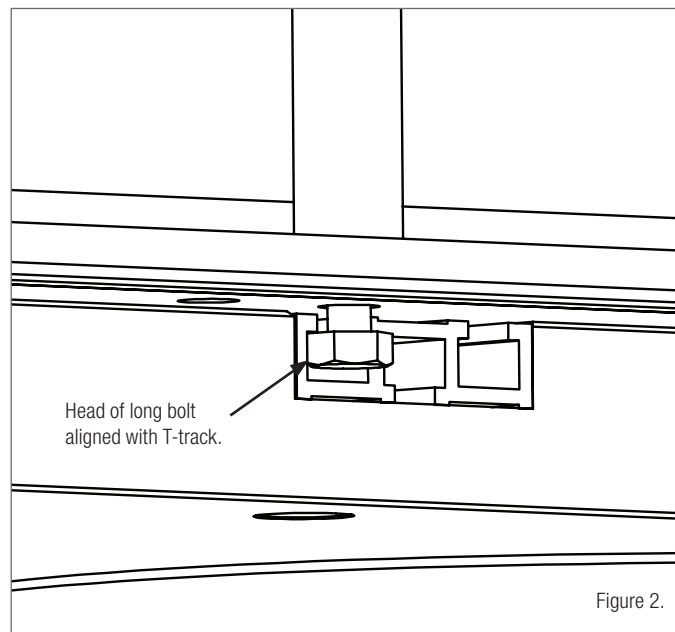

Figure 2.