

Woodpeckers[®]

CHAMFER & RADIUS QUICK-JIG

OWNER'S MANUAL

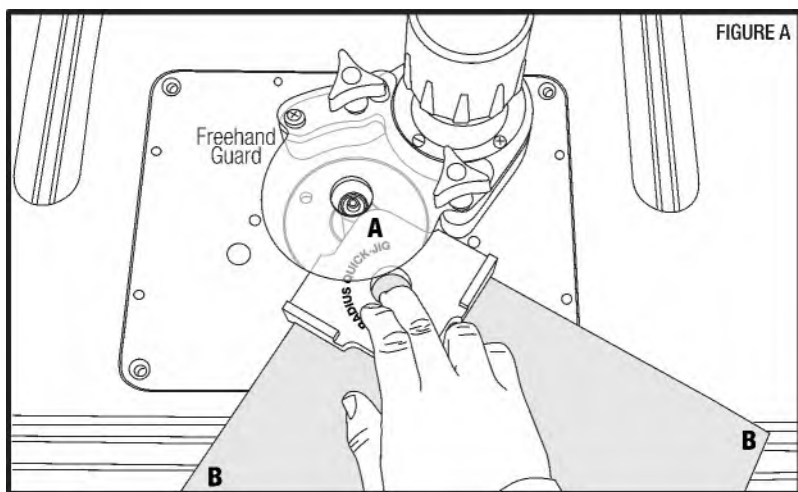

WARNING! To reduce the risk of injury keep hands away from moving parts. Refer to your owners manual for proper setup and use.



WARNING! To reduce the risk of injury, wear safety goggles or glasses with side shields, ear protection & a dust mask.

IMPORTANT: The Chamfer & Radius Quick-Jig is designed specifically for use with table mounted routers. **DO NOT USE WITH HAND HELD ROUTERS.** The Chamfer & Radius Quick-Jig is shown above in use with the Woodpeckers Freehand Guard (sold separately).

- Proper feed direction is critical to safe operation and a smooth finish. Looking down from the top with the jig held firmly in place, the workpiece should be fed into the router bit from right to left. The router bit should be on a counter-clockwise path.

- The stock should always feed into the router from the long grain edge around to the end grain. This means that you have to rout two diagonally opposed corners from each side of the board. In the illustration, the "A" corners are done as shown, then the board is flipped over to do the "B" corners. **FIGURE A.**



Scan the QR code above to watch the video or visit woodpeck.com under the video tab towards the bottom of the product page.

If you think you're missing anything, email us at mailroom@woodpeck.com. You can also call us at 800-752-0725 from 9:00 a.m. to 4:00 p.m. EST Monday - Friday.

HOW TO GET THE BEST RESULTS FROM YOUR CHAMFER & RADIUS QUICK-JIG

The Chamfer & Radius Quick-Jig is a template for marking chamfers and corner radii and also serves as a template for guiding along flush trim style router bits. The router bit must have a guide bearing on the tip. Common diameters are 1/2" to 3/4". The cutting edge of the bit should extend just barely above the wood but not so much that the cutters will come in contact with the aluminum Chamfer & Radius Quick-Jig. The bearing should ride solidly against the edge of the Quick-Jig.

IMPORTANT: The Chamfer & Radius Quick-Jig is designed specifically for use with table mounted routers. **DO NOT USE WITH HAND HELD ROUTERS.**

1. Pull the chosen Quick-Jig down onto the corner of the wood and hold it firmly in place, slowly feed it into the router bit. **FIGURE B.**
2. Follow around the profile with the material and jig rotating in a counter-clockwise direction. A better finish can be achieved if small amounts are removed in multiple passes versus one heavy pass. **FIGURE C.**

WARNING! Keep hands, fingers, clothing and everything else well away from the router bit and the outside edges of the jig. **DO NOT HOLD THE JIG FROM THE SIDES.** The center hole is a good place to pull back from. Pull in the direction shown in **FIGURE B.**

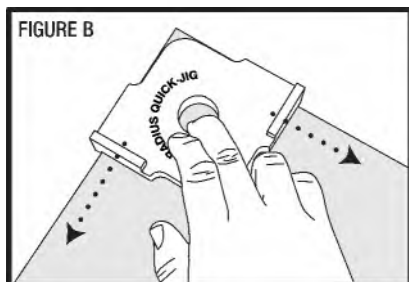

Pull the Quick-Jig down onto the corner of the wood.

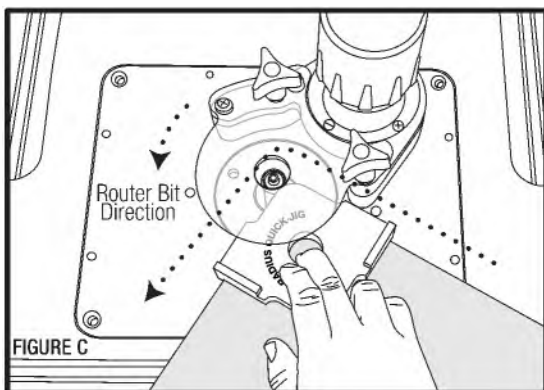

Pull the Quick-Jig/Wood in a counter-clockwise direction.

Woodpeckers®

Woodpeckers, LLC Strongsville, Ohio

woodpeck.com

© 2023 Woodpeckers, LLC



woodpeck.com

At Woodpeckers we are constantly reviewing & improving our tools. The most current version of our instruction manuals are always available to download at woodpeck.com.

(Located in the bottom section of the tool's page under the "Additional Information" or "Instructions" tabs.)



Be the first to know all the new products, **OneTIME Tools & sales** by subscribing to our eClub. (Located at the top center of our webpage woodpeck.com.)



Subscribe to our YouTube channel to stay up-to-date on all the latest tool tips & tricks.



INTERACT WITH US! Follow us on Facebook, Instagram & TikTok!



Enjoy shop tips, project ideas, tool techniques & more in our Woodworking Resource Center/Blog. (Located at the bottom center of our webpage woodpeck.com.)



WARNING! This product can expose you to chemicals, including chromium, which is known to the State of California to cause cancer and birth defects or other reproductive harm. For more information go to www.P65Warnings.ca.gov