

Woodpeckers®

MARKING & PANEL GAUGE

OWNER'S MANUAL

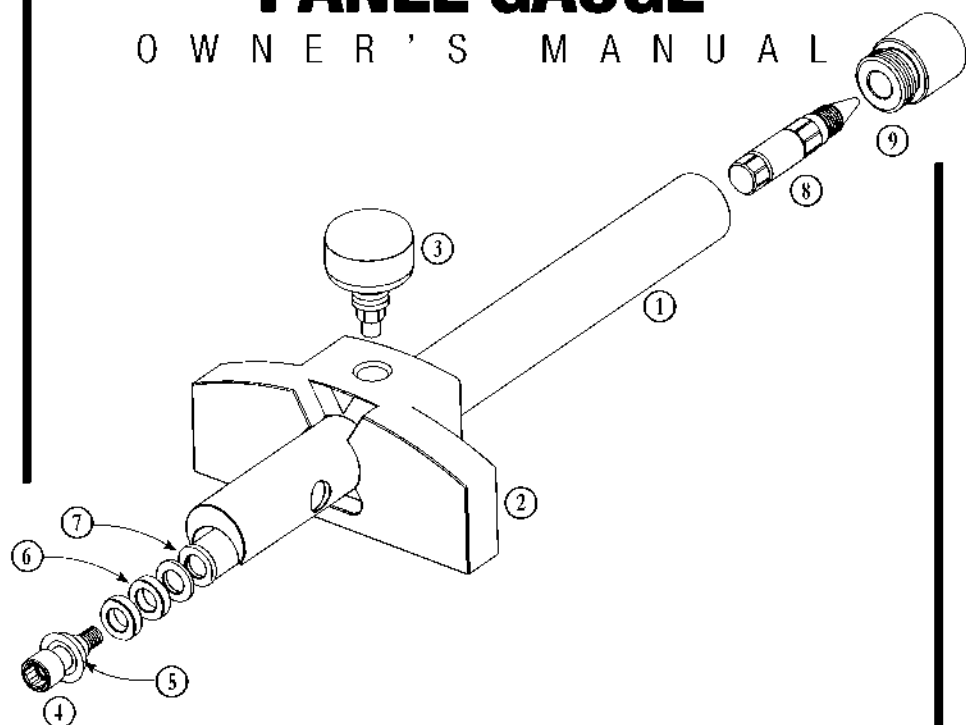

DIAGRAM NUMBER	(QTY) PART NAME
①	(1) Bar
②	(1) Fence
③	(1) Clamp Knob/Hex Drive
④	(1) Shoulder Screw
⑤	(2) Scribe Wheel
⑥	(2) 1/8" Spacer
⑦	(2) 1/16" Spacer
⑧	(1) Mechanical Pencil
⑨	(1) Cap



To watch video on this product
visit woodpeck.com
on the product page
-OR- visit our YouTube page
youtube.com/@WoodpeckersLLC

If you think you're missing anything, email us at mailroom@woodpeck.com.
You can also call us at 800-752-0725 from 9:00 a.m. to 4:00 p.m. EST Monday - Friday.

BASIC ASSEMBLY

The basic assembly of your Marking Gauge is shown in **FIGURE A**.

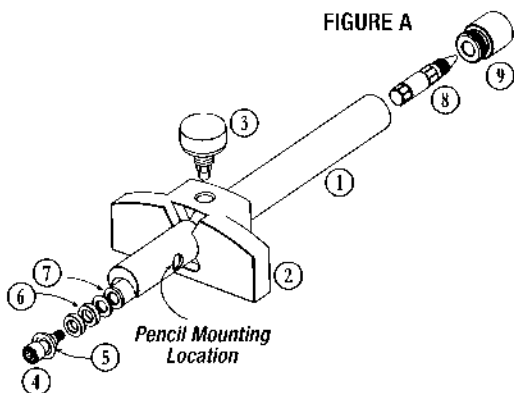
NOTE: The Clamp Knob (3) has a Hex Drive near the bottom for use tightening and untightening the Scribe Wheel (5) and Spacer (6)/(7) assemblies.



SCRIBING WHEELS

The Marking Gauge creates both scribe lines and Mechanical Pencil (8) lines in your work piece. Although the Scribe Wheels (5) are round, they will leave a deeper mark if they don't turn while being drawn across the material. Scribe lines cannot be erased, practice on scrap material first to verify your setting.

To prevent the Scribe Wheels turning, the correct number of Scribe Wheels and Spacers must be assembled on the Shoulder Screw (4) and fully tightened.

FIGURE B.

The Scale on the Bar (1) is measured from the Scribe Wheel (5), which must be oriented with the larger face against the head of the Shoulder Screw (4). The total combined thickness of Spacers and Scribe Wheels must equal 1/2".

FIGURES B and C. Each Scribe Wheel is 1/8" thick. (2) Spacers are also 1/8" thick and (2) Spacers are 1/16" thick.

You may assemble different configurations of Scribe Wheels and Spacers to make variety of double scribe lines. **FIGURE D.** Most common marking applications use only one Scribe Wheel.

NOTE FOR METRIC GAUGES: The metric version of the tool includes (2) 2.5mm thick Scribe Wheels and Spacers to create 5, 6, 8, 10, 12 and 14mm spacing.

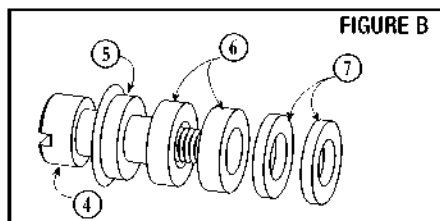

Single Wheel marking with first Scribe Wheel up against head of shoulder screw.

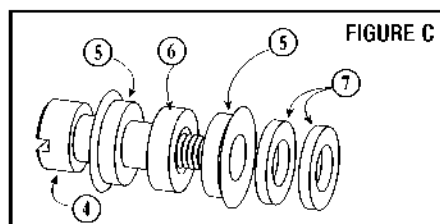

Two Wheel configuration for 3/8" spaced marks.

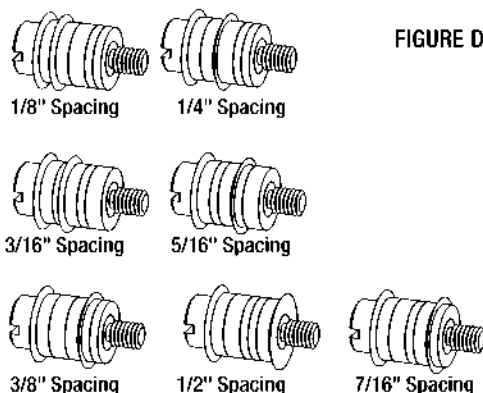
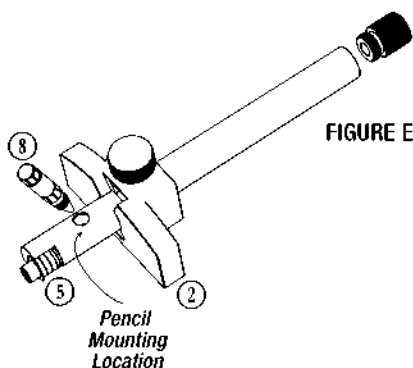

FIGURE D

SETTING THE FENCE

Two sets of Scales are engraved on the Marking Gauge Bar. When scribing, position the Fence (2) on the Scale that is opposite, or above, the Marking Wheel.

When using the Mechanical Pencil (8), position the Fence (2) to use the Scale that is in line with the threaded, Pencil Mounting Location. To set the Fence, align the back of the notch in the Fence with your desired dimension. **FIGURE E.**



MARKING WITH PENCIL

Remove the Mechanical Pencil (8) from the Cap (9) at the end of the Bar (1) by simply unscrewing it. Mount the Mechanical Pencil in the Bar by screwing it into the Pencil Mounting Location near the front end of the Bar.

You can extend or retract the pencil lead by turning the screw on the end opposite the lead.

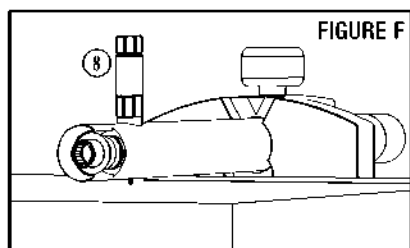

To prevent excessive lead breakage, adjust the lead so that it projects only about 1/16" from the Bar.

SHARPENING THE SCRIBE WHEEL

NOTE: The (2) Scribe Wheels included with your Marking Gauge have been heat-treated and faced to a moderately sharp edge which will leave a noticeable mark in most woods. If a sharper mark is desired, follow the directions below to further sharpen the Scribe Wheels.

To sharpen a Scribe Wheel, lay it down flat on a fine-grit stone, lubricate with water or oil (*depending on stone type*) and apply light, even, downward pressure with one finger, while moving it in small circles traversing the length of the stone. When done, thoroughly dry the Scribe Wheel. Water may cause it to rust. After repeated scribing, the Wheel will dull. Switch to a sharp section of the Wheel by loosening the Screw and rotating the Scribe Wheel to a fresh edge and tighten the Screw.

AVOID EXCESSIVE RE-SHARPENING: Excessive sharpening of the Scribe Wheel will reduce its thickness to the point where it can no longer be clamped with the Shoulder Screw.

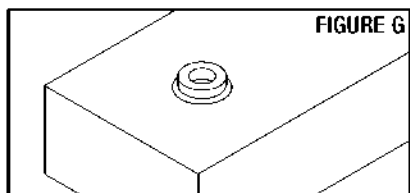

Scribe Wheel face down on sharpening stone.

Woodpeckers®

Woodpeckers, LLC Strongsville, Ohio

woodpeck.com

© 2024 Woodpeckers, LLC



woodpeck.com

At Woodpeckers we are constantly reviewing & improving our tools. The most current version of our instruction manuals are always available to download at **woodpeck.com.**

(located in the bottom section of the tool's page under the "Additional Information" or "Instructions" tabs.)



Be the first to know all the new products, *OneTIME Tools* & sales by subscribing to our eClub. (Located at the top center of our webpage **woodpeck.com.)**



Subscribe to our YouTube channel to stay up-to-date on all the latest tool tips & tricks.



INTERACT WITH US! Follow us on Facebook, Instagram & TikTok!



Enjoy shop tips, project ideas, tool techniques & more in our Woodworking Resource Center/Blog. (Located at the bottom center of our webpage **woodpeck.com.)**



WARNING! This product can expose you to chemicals, including chromium, which is known to the State of California to cause cancer and birth defects or other reproductive harm. For more information go to www.P65Warnings.ca.gov