

Woodpeckers Box Clamp Instructions

(Patent Pending)



Hardware Pack

HAND CLAMP MODE HARDWARE



1/4-20 x 1-1/2"
Hex Bolt



1/4"
Washer



3-Wing Knob

Overview

The Woodpeckers Box Clamp is designed for clamping cases, drawers, cabinets and virtually any other box assembled from material 1/4" – 1" thick. It's main advantage is it's ability to apply simultaneous in and downward pressure against two perpendicular pieces.

Your Box Clamp can be assembled in "fixture mode" or "hand clamp mode". In both cases the clamp works the same way. The difference is from which side of the clamp you're working. In fixture mode the clamp is typically set down on a bench with the material set into the clamp and is tightened using the clamp screw.

In hand clamp mode the material is on the bench and the clamp is set onto the material tightened with the clamp knob.

Switching between these two modes takes less than a minute. Hardware for both modes included.

To secure clamp to bench or fixture, we recommend using #10 - #12 flat head screws.

For best results, clamped work pieces should be of the same thickness within approximately 1/32".



Corner Joint



T-Joint



Miter Joint

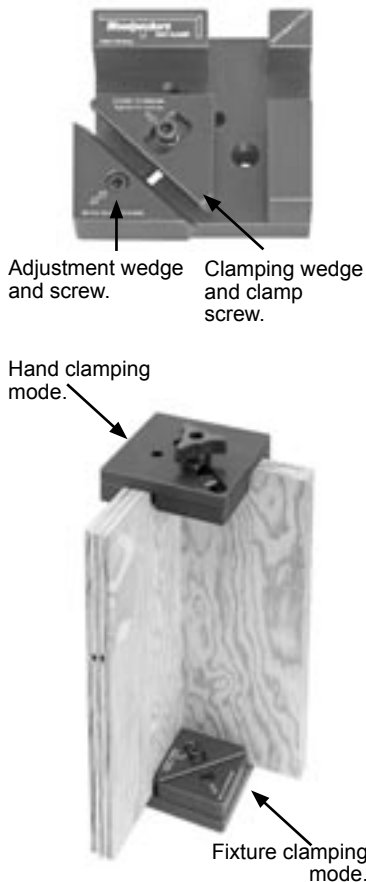

Adjustment wedge and screw. Clamping wedge and clamp screw.

Hand clamping mode.

Fixture clamping mode.



Step 1 SETTING STOCK THICKNESS

With both screws loose, (unscrew clamping screw or knob at least two turns), slide wedges in and against your setup material. Firmly tighten adjustment screw. (Small scraps work well for this step.)



Step 2 TIGHTENING CLAMPING WEDGE

Remove setup pieces, insert work pieces and tighten clamp screw or knob.

(Note: A dab of white lithium grease between the two wedges will make it easier to release clamping pressure.)

Woodpeckers Box Clamp Instructions

(Patent Pending)

Page 2

Assembling for Hand Clamp Mode

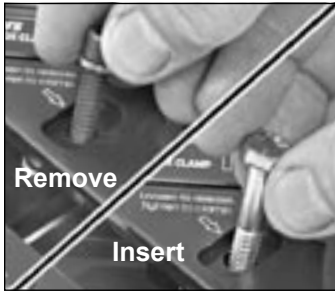

Step 1 SWITCH SCREWS
Remove socket set screw and small washer, install hex bolt with same washer.



Step 2 ATTACH KNOB
Remove and save 1/4 square nut from underneath. Install 1/4" washer (smooth side down) and knob.



Step 3 CLAMP MATERIAL
Straddle joint, tighten knob.

Examples



FIXTURE EXAMPLE Multiple Box Clamps can be arranged for clamping entire frames and assemblies. They can be used loose or attached to a wooden base to speed up use.



COMBINATION EXAMPLE Box Clamps can be used in sets. This is especially useful when clamping deeper boxes or cabinets.

Mfg. by: **Woodpeckers Inc.**
11050 Industrial First
North Royalton, Ohio 44133

Tel: (440) 230-2442
www.woodpeck.com