

Side Crank

Accessory

INSTALLATION INSTRUCTIONS

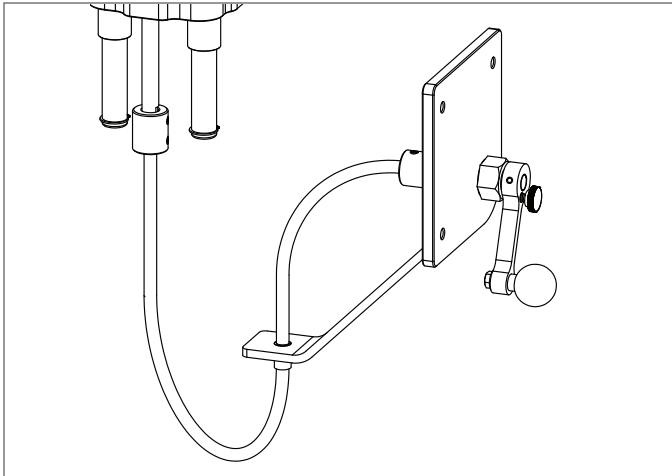

Made in U.S.A. by Woodpeckers Inc.

SAFETY

Always unplug your router motor before installing or using this device. Follow all recommendations of the router manufacturer.

BEFORE YOU BEGIN

The Woodpeckers® Side Crank Accessory is designed to be used with the Woodpeckers® Precision Router Lift or Quick Lift. It will require some minor modifications to your router table stand or cabinet for proper installation.

Regardless if your router table is mounted to a steel stand or wooden cabinet, spacing of the side crank panel relative to the lift screw is important and should be kept to the recommended dimensions.

Slight variations of an inch or so in any direction can negatively or positively affect performance. We encourage testing before committing to a particular mounting location.

Usually, unwanted twisting or swinging of the flex shaft can be minimized by mounting the panel off center and not in line with the lift rod. In fact in some circumstance it will crank more easily from the front instead of the side. Again, a little time spent experimenting will make a difference.

Finally, the attachment coupling supplied with this tool is designed to adapt to a 1/2" diameter shaft. Although the Side Crank Assembly is designed for the specific router lifts mentioned above, it might be useful in other applications and may require a different coupling. At this time the included coupling is the only one Woodpeckers manufactures.

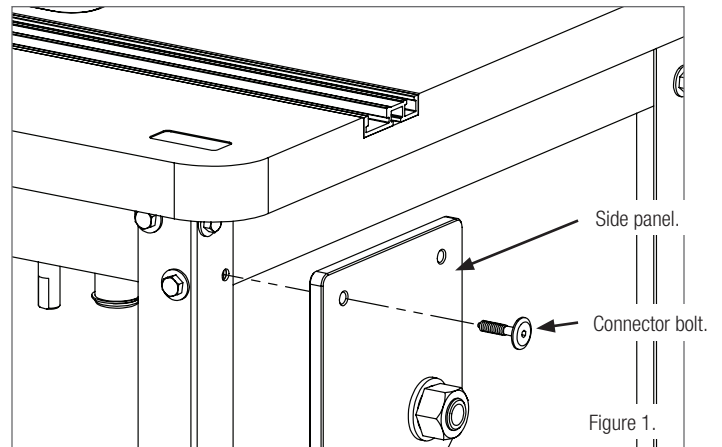

SIDE CRANK INSTALLATION ON THE WOODPECKERS® ROUTER TABLE STAND

This section assumes you're installing the Side Winder onto the Woodpeckers® Router Table Stand.

Figure 1. Remove the existing hex bolt from the corner of the router table stand and attach the side panel using one of the connector bolts and hex nuts.

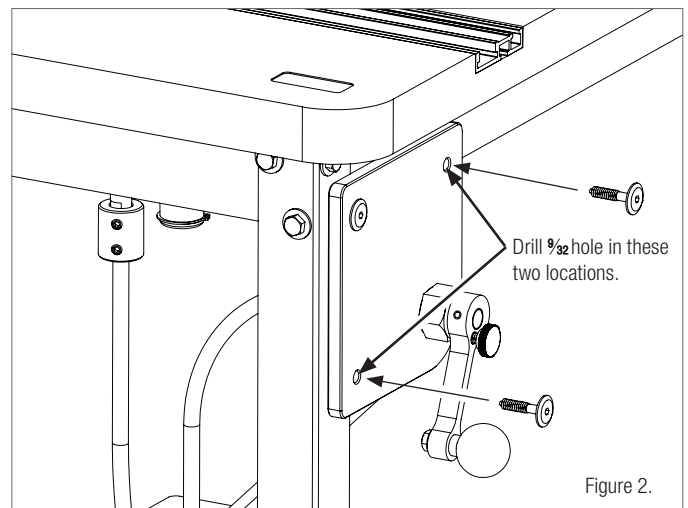

Figure 2. Using the side panel as a guide, drill two 1/32 dia. holes through the router table stand. Fasten the panel in place using the remaining connector bolts and nuts.

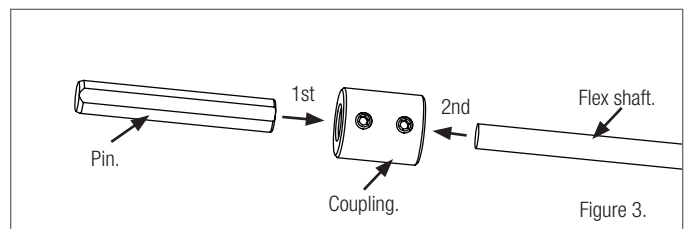

Figure 3. First slip the pin into one of the couplings. Make sure it bottoms out. Tighten the set screw onto the flat of the pin. Now push the flex shaft into the other end of the coupling. Tighten the remaining set screw. Now loosen the first set screw and remove the pin. You'll need it for the next step.

Figure 4. Assemble the remaining coupling and pin together. Make sure the set screw is tight on the flat spot of the pin. Now thread the end of the flex shaft up through the bearing in the bracket and slide the coupling onto the end of the flex shaft. Tighten the set screw that holds the flex shaft. Now both ends of the flex shaft should have couplings attached and the end going up through the bracket should have the pin installed as well.

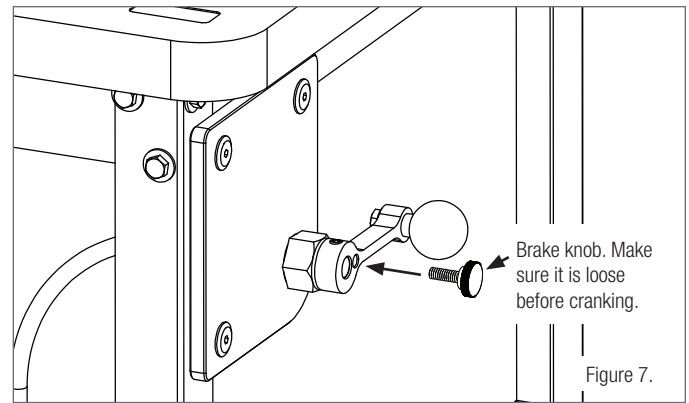
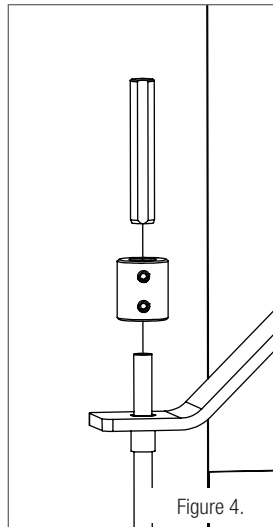

Figure 7. Now thread the brake knob into the threaded hole in the handle. **Make sure this knob is not tight before cranking. Damage to the bearing surface will occur if rotated while the brake knob is tight.**

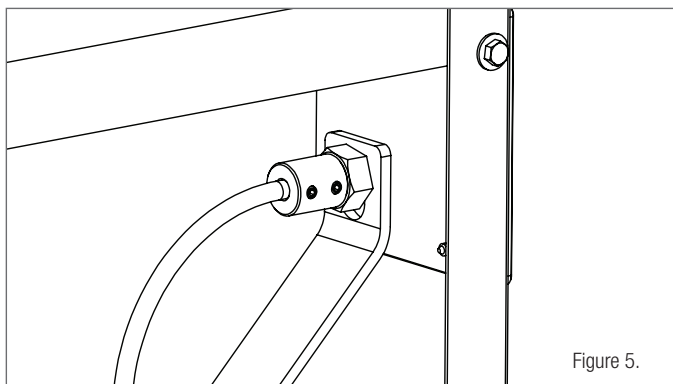

Figure 5. Apply a dab of grease on the outside of the pin and insert it through the hole in the side panel bolt. **This will take some effort.** Be careful not to kink the flex shaft. Bend it just enough to get the pin through the hole.

If necessary you can loosen the bracket by partially loosening the large bolt. That might make it easier.

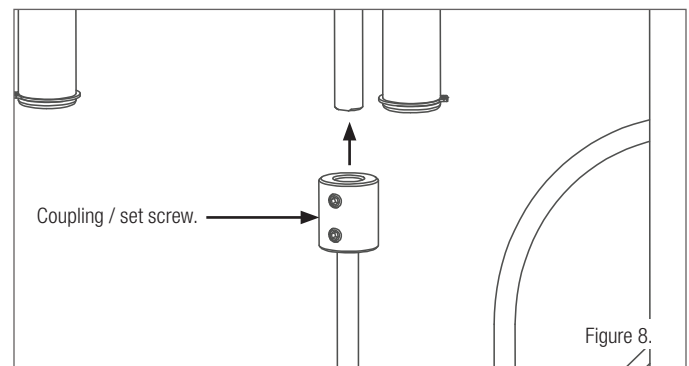

Figure 8. Attach the remaining coupling on the other end of the flex shaft and then to the lift rod of your router lift. Make sure to fully insert the lift rod into the coupling. Firmly tighten both set screws. Use the crank handle to turn the flex shaft and coupling. If the coupling or flex shaft turns without the lift rod turning, the set screws may not be tight enough.

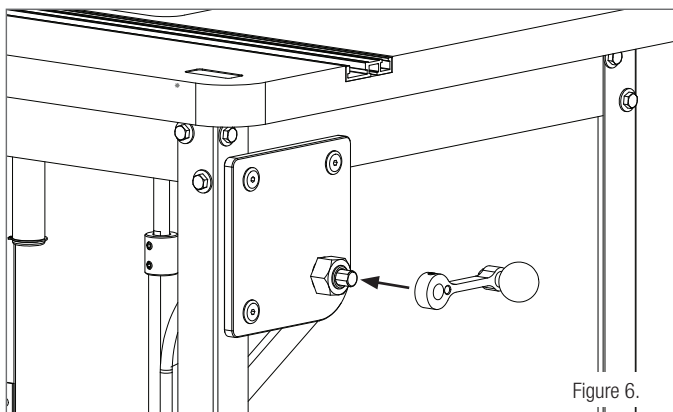
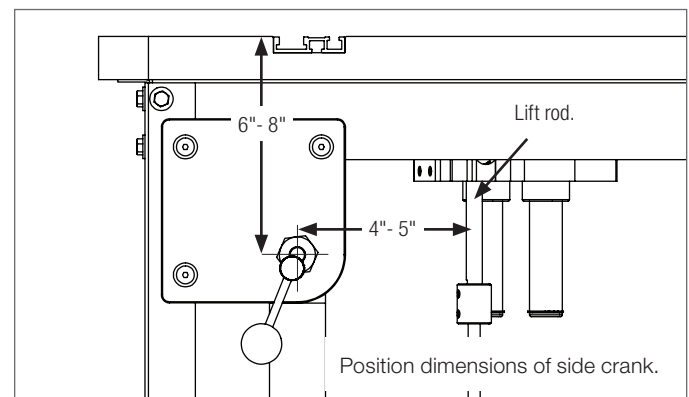

Figure 6. From the outside, slip the crank handle onto the pin, align the end of the pin with the face of the handle, align the set screw with the flat spot on the pin and tighten the screw.

Double check that the handle has a little bit of in and out play. If it's tight, the handle will not crank freely.



SIDE WINDER INSTALLATION ON NON-WOODPECKERS® ROUTER TABLE STANDS.

The Woodpeckers® Side Winder can be installed on non-Woodpeckers® cabinets and router table stands. The above illustration shows the general location of the crank handle relative to the router table top and router lift. It's recommended that the side panel be mounted in its entirety and not disassembled.