

## DRILL PRESS TABLE

### Assembly Instructions

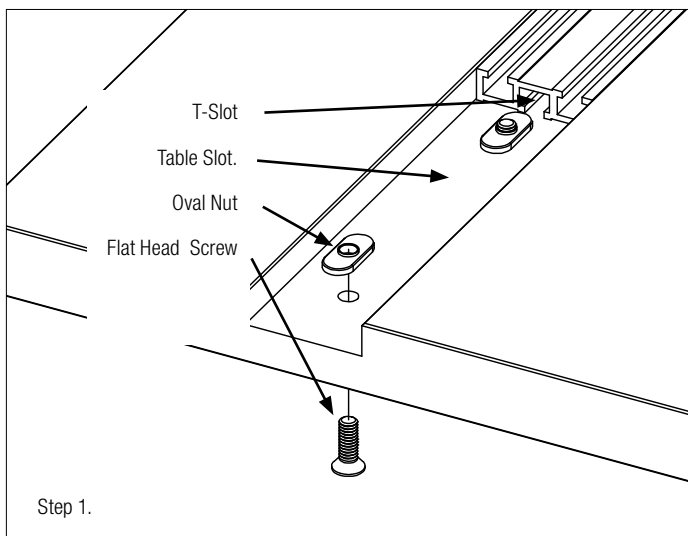
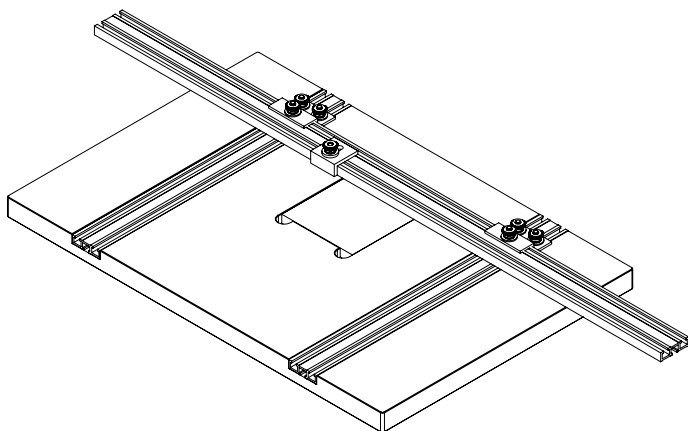

#### STEP 1: Installing the Table Track.

Each of the two tracks mount into the table using a series of flat head screws and oval nuts. Insert a screw up from the bottom of the table and start threading on an oval nut. Repeat this for all four screws in each of the two table slots.

Once all the screws are assembled into the table, orient a piece of track with the single T-slot side facing down. Slide it through the table slot so that all the oval nuts thread into the T-Slot. Line up the track flush with the front edge of the table. Tighten all four screws. Repeat this process for the second track. Do not overtighten. Damage to the track can occur.

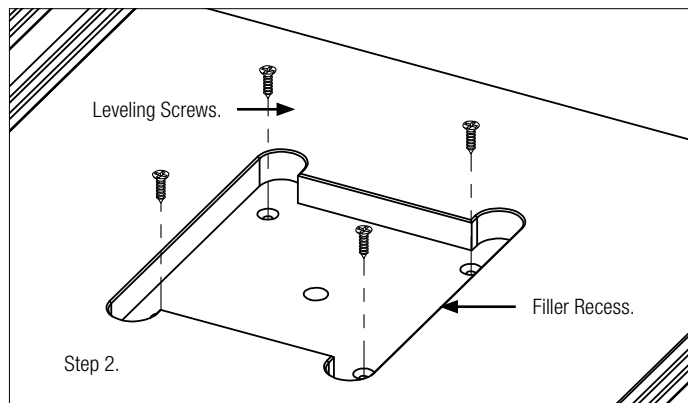

#### STEP 2: Installing the Leveling Screws.

Thread in the four little flat head screw until they're flush with the bottom of the recess. These screws are used to bring the 1/2" thick filler flush with the top of the table.

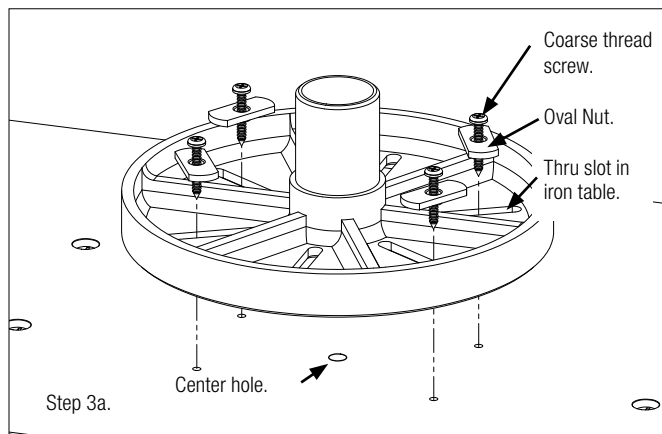

#### STEP 3a: Attaching To a Through Slotted Table.

Basically there are two types of drill press tables, those with through slots and those without. Illustration 3a shows how to attach your Woodpeckers Drill Press Table to one with through slots. Step 3b shows the installation without through slots.

Remove the original table, from your drill press. Set it face down onto your Woodpeckers table which should also be face down. While looking down through the tube, center the original table over the 3/8" hole in the Woodpeckers table.

Now mark four screw locations. Carefully pick locations that are well away from the filler recess on the opposite side. Pre-drill the four locations using a 5/32" drill bit to a depth of approximately 3/4". Use the four oval nuts to span the slots in the platter. Secure the tables together by installing all four coarse thread screws through the oval nuts and into the Woodpeckers table.

#### STEP 3b: Attaching To a T-slotted Table.

If your drill press table has T-slots instead of through slots, you'll need to make an adaptor board that's approximately 15 1/2" x 23 1/2" x 3/4" in thickness.

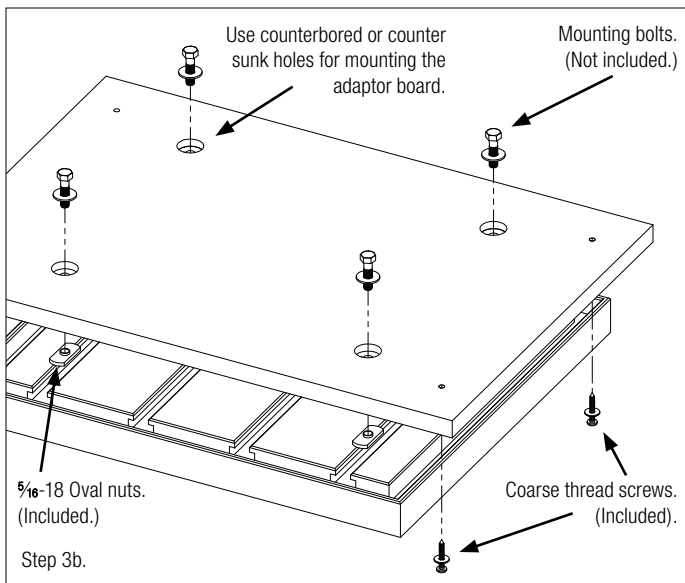

The four coarse thread screws and the four oval nuts can be used for this approach. However you'll need to supply the bolts needed for attaching the adaptor board to your drill press table. Your bolts should match the 5/16-18 thread of the oval nuts. The oval nuts fit into most drill press table T-slots. Match them up with bolts that are of the length necessary to attach the adaptor board without bottoming out in the slot.

Begin by selecting four locations for mounting bolts. Accurately mark these locations ensuring that they are perfectly centered to the T-slots.

The through holes should be about 3/8" in diameter. Illustration 3b shows counter bored holes made with a forstner bit and a standard 3/8" drill bit. Counterbored holes are best for hex head bolts. If you plan on using flat head screws then substitute a counter sunk hole instead of a counter bored one. Most hardware stores sell countersink bits for this purpose.

Once you've attached the adaptor board to your drill press table, use the four coarse thread screws and washers to attach the

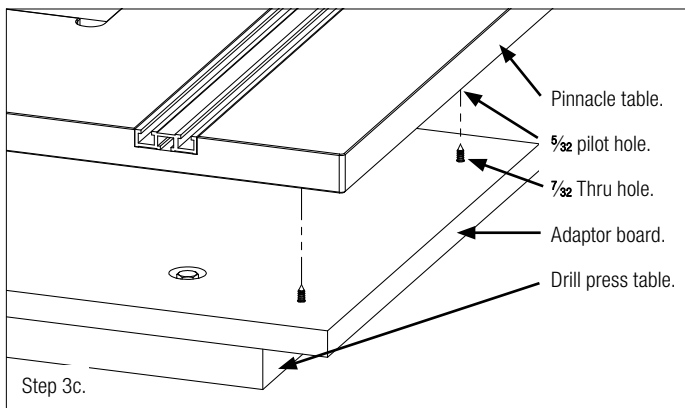

Woodpeckers table to the adaptor board. This will require pre-drilling 5/32" diameter holes into the bottom of Woodpeckers table and 7/32" holes through the adaptor board for the coarse thread screws.

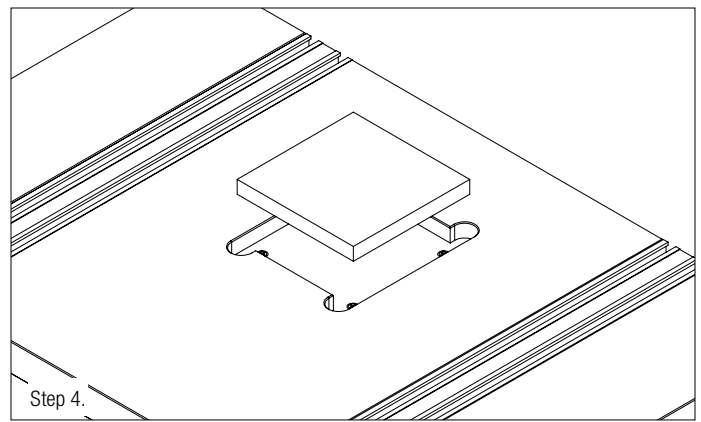

#### STEP 4: Install Filler.

Set the 4 x 4 x 1/2 filler into the recess. This is a sacrificial piece that can be easily replaced to minimize tearout as the drill bit exits the material.

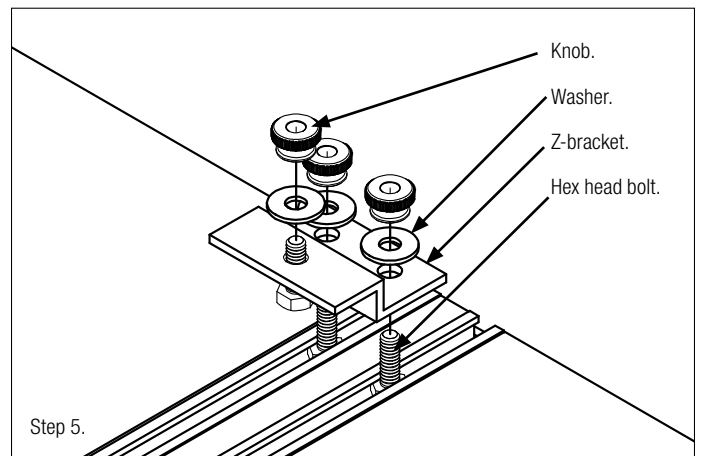

#### STEP 5: Install Two Z-Brackets.

You'll need three hex head bolts, washers and knobs plus one Z-bracket. Slide one bolt into each t-slot as shown. Set the Z-bracket onto the two bolts. Drop a washer over each bolt and start the knobs.

At this point the Z-bracket should be loose. Slip another bolt up through the single hole in the upper horizontal flange. Again drop a washer onto the screw and start a knob.

Repeat this same procedure for the second Z-bracket.

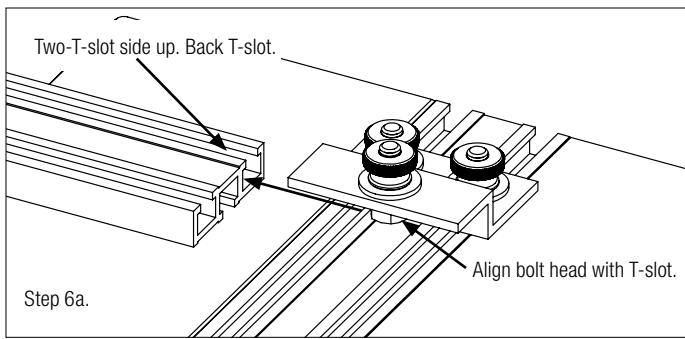

**STEP 6: Installing the Fence.**

After both Z-brackets have been installed make sure that all three knobs on each Z-bracket are loose. Orient the fence so that the two-T-slot side is facing up as shown in 6a. You'll know it's right if you can read the scale. You can slide the fence on from either direction. Orient the head of the first bolt so that it will slide into the slot.

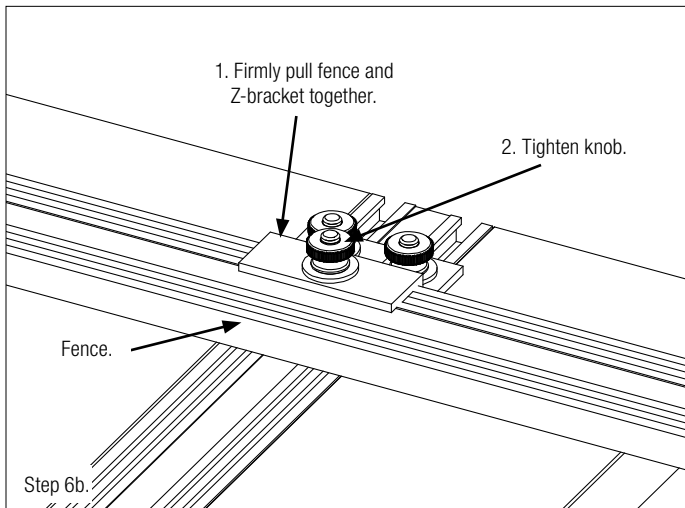

Continue sliding the fence over to the second Z-bracket. Again orient the head of the bolt so it'll slip into the T-slot.

As shown in 6b, firmly pull the fence and bracket together, tighten the knob and repeat for the other bracket.

Each Z-bracket has two knobs toward the rear that when tight prevent the fence from sliding backward and forward. Loosen these four knobs and make sure the fence can be adjusted.

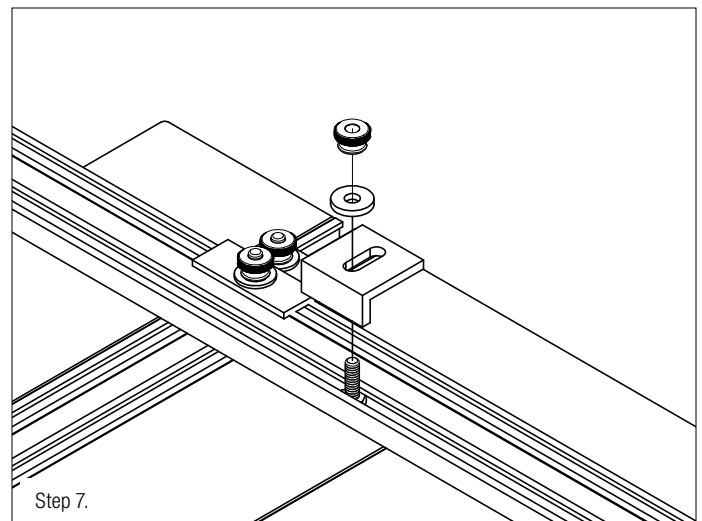

**STEP 7: Installing the Stop.**

Align the head of hex bolt with the forward most T-slot in the fence. Slide it over toward the center of the table. Set the L-stop onto the bolt. Drop on a nylon washer and thread on a knob. Once the knob is position the desired distance from the drill bit, tighten the knob to secure its position.